

COMPRESSOR BELT POSITION

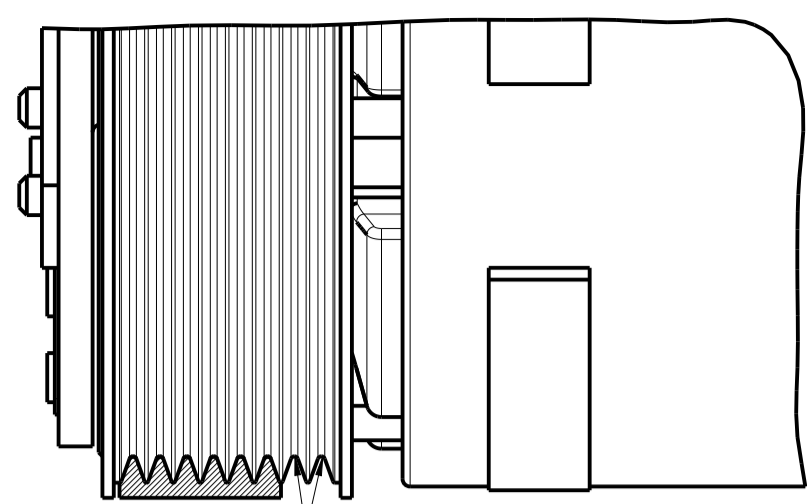

THE TWO REAR GROOVES FREE

ATTENTION

VERIFY THE CORRECT LINE UP PULLEYS AND THE PARALLEL ALIGNMENT WITH A RULE

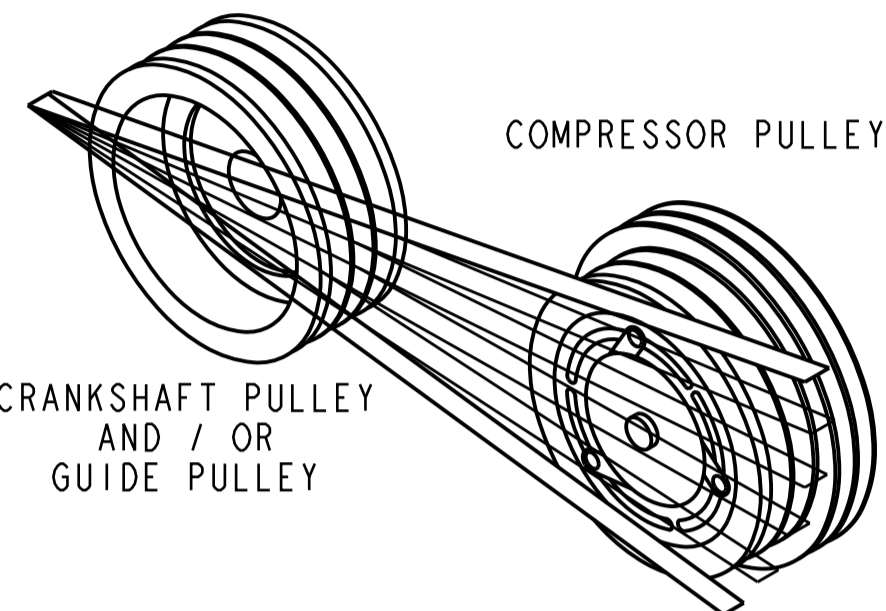

COMPRESSOR PULLEY

CRANKSHAFT PULLEY AND / OR GUIDE PULLEY

FIXATION OF COMPRESSOR HOSES

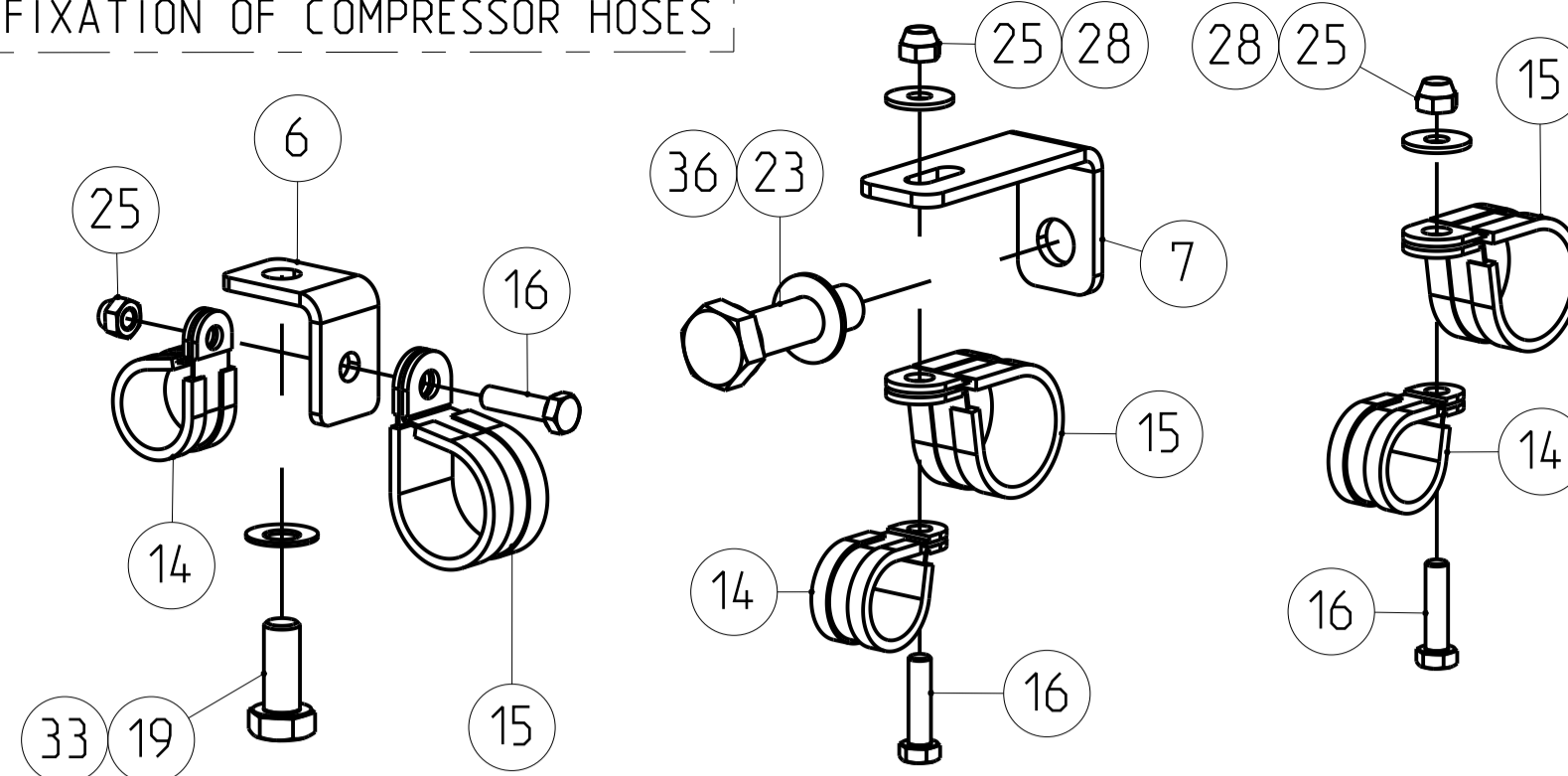

ONLY MOUNT ON VEHICLES ORIGINALLY WITHOUT A/C

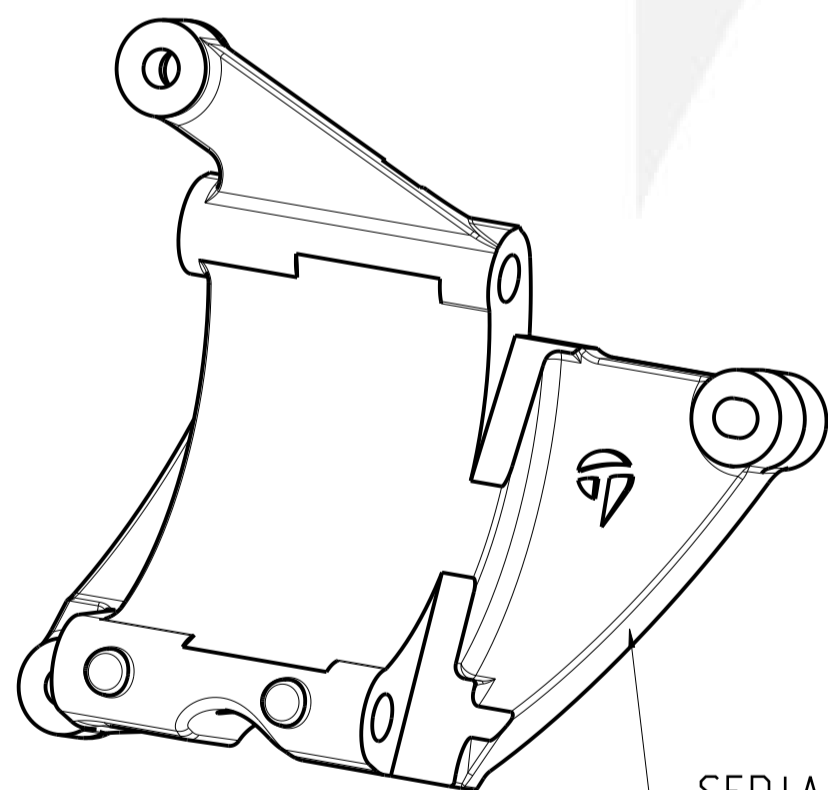
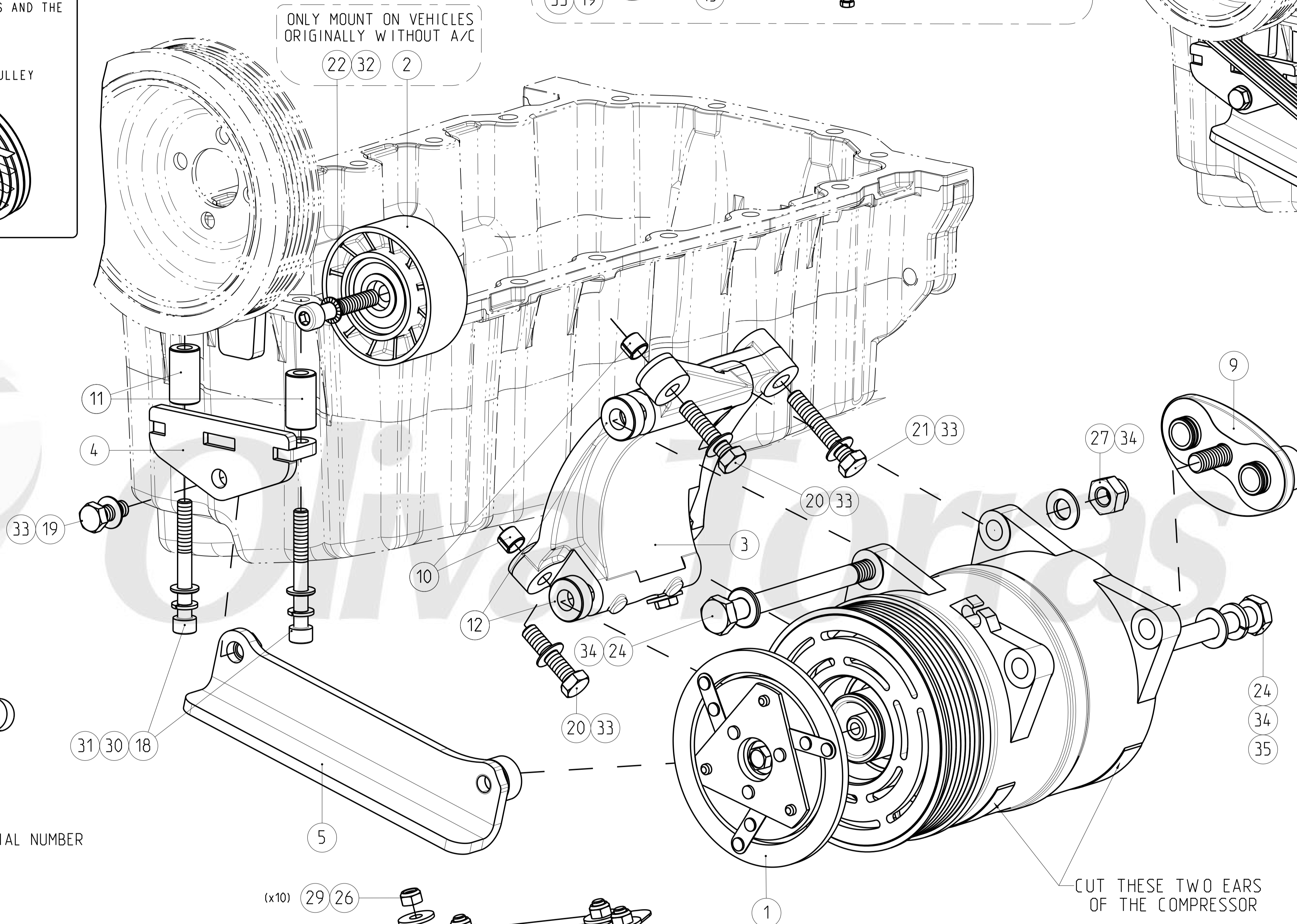
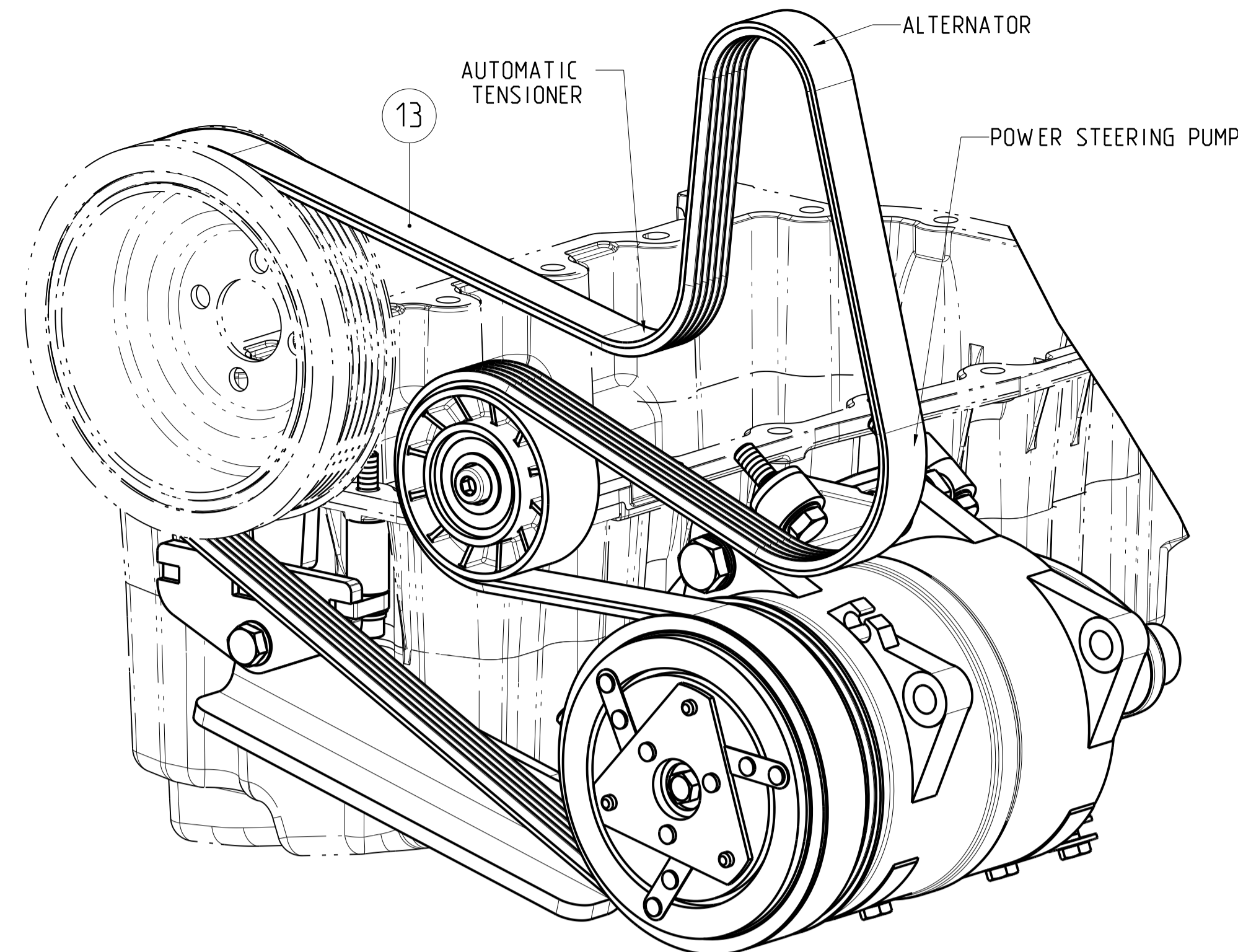

SERIAL NUMBER

CUT THESE TWO EARS OF THE COMPRESSOR

KIT WITH CLUTCH

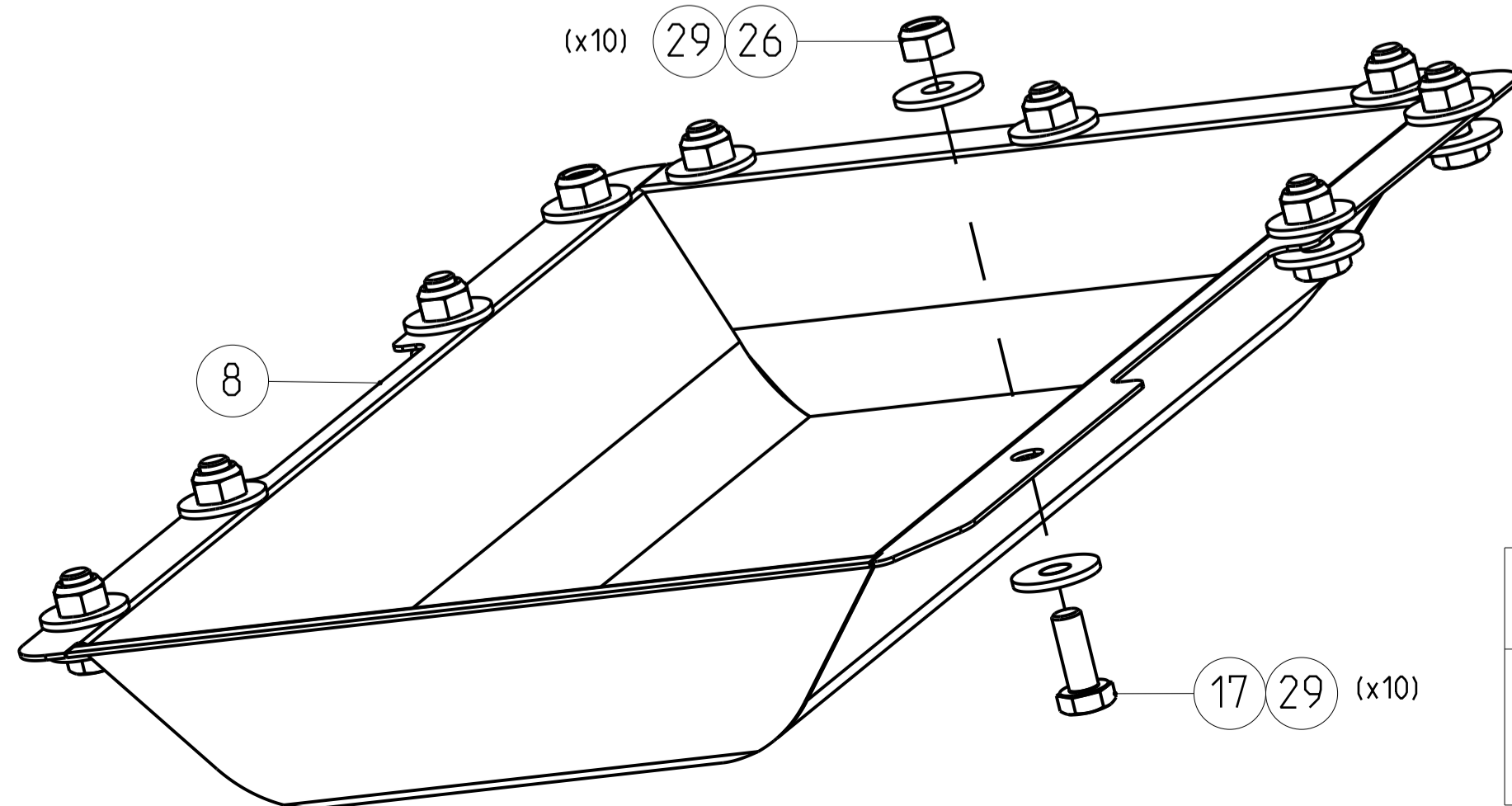
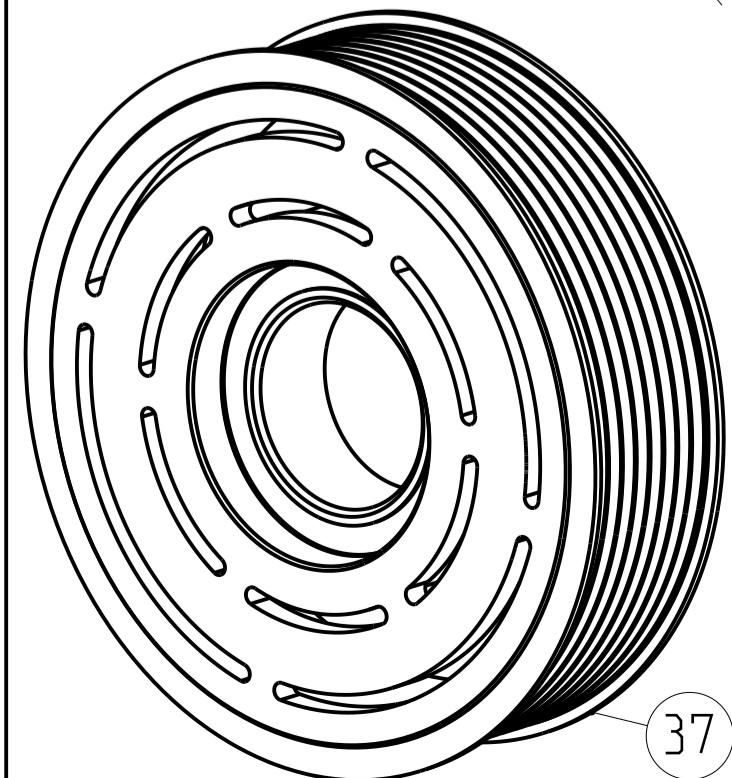

Id.	Part No.	Qty.	Description
1	1112040000	1	LEAF SPRING PLATE
2	1118000405	1	BACK IDLER PULLEY Ø70
3	1120000405	1	COMPRESSOR BRACKET
4	1121000405	1	OIL SUMP BRACKET
5	1122000405	1	COMPRESSOR REINFORCEMENT
6	1140000012	1	COMPRESSOR HOSES FIXATION
7	1149000383	1	COMPRESSOR HOSES BRACKET
8	1158000405	1	PROTECTION COVER
9	1170000004	1	HORIZONTAL MANIFOLD
10	1173010041	2	BUSH Ø11 x Ø9 x 8.5
11	1201507275	2	SPACER Ø15 x Ø7.5 x 27.5
12	1202210084	2	SPACER Ø22 x Ø10.5 x 8
13	1260601635	1	BELT POLY-V 6PK1635
14	1280021812	3	PIPE CLIP Ø18/12
15	1280022515	3	PIPE CLIP Ø25/15
16	930502001000	3	HEXAGON HEAD BOLT DIN 933 M5x20 8.8
17	930601601000	10	HEXAGON HEAD BOLT DIN 933 M6x16 8.8
18	930706005022	2	SOCKET HEAD SCREW DIN 912 M7x60 12.9
19	930802001020	2	HEXAGON HEAD BOLT DIN 933 M8x20 12.9
20	930803501020	2	HEXAGON HEAD BOLT DIN 933 M8x35 12.9
21	930804501020	1	HEXAGON HEAD BOLT DIN 933 M8x45 12.9
22	930804505000	1	SOCKET HEAD SCREW DIN 912 M8x45 8.8
23	931004001000	1	HEXAGON HEAD BOLT DIN 933 M10x40 8.8
24	931013002000	2	HEXAGON HEAD BOLT DIN 931 M10x130 8.8
25	940050982000	3	LOCK NUT DIN 982 M5 8.8
26	940060985000	10	LOCK NUT DIN 985 M6 8.8
27	940100982000	1	LOCK NUT DIN 982 M10 8.8
28	950059021000	2	FLAT WASHER DIN 9021 Ø5
29	950069021000	20	FLAT WASHER DIN 9021 Ø6
30	950070125000	2	FLAT WASHER DIN 125 B Ø7
31	950070127102	2	SPLIT LOCK WASHER DIN 127 Ø7
32	950080000002	1	AET WASHER AET Ø8
33	950082093002	5	SPRING WASHER DIN 2093 Ø8
34	950100125000	3	FLAT WASHER DIN 125 B Ø10
35	950100127102	1	SPLIT LOCK WASHER DIN 127 Ø10
36	950102093002	1	SPRING WASHER DIN 2093 Ø10

KIT WITH CLUTCH

Id.	Part No.	Qty.	Description
37	1196000300	1	COMPRESSOR PULLEY Ø119 Poly-V 8PK

Engine	Compressor	Clutch
Ø138 @ 3500 r.p.m.	Ø119 @ 4058 r.p.m.	With
	Ø119 @ 4058 r.p.m.	Without

REV	NAME	DATE	MODIFICATION	DATE	NAME
	Dani.F	20-Nov-15	MOUNT & DRIVE KITS		
	J.Petit	20-Nov-15	REVISION: A		
	J.C. Puigtró	20-Nov-15			

DRAWN: Dani.F
 CHECKED: J.Petit
 APPROVED: J.C. Puigtró

KIT N°: PAGE N°: 1 of 7
 VW TRANSPORTER T6 (without A/C) KC 15110405

This document contains proprietary information of the OLIVA TORRAS, S.A. It is transmitted to you in confidence and trust, and is to be returned upon request. Its contents may not be disclosed in whole or in part to others or used for other than the purpose for which transmitted without the prior written permission of OLIVA TORRAS, S.A.