

## FMS037-1FBM01MB

Holder of Front boxes Mercedes/Setra 2010> on the front panel for 1 monitor  
(left side)

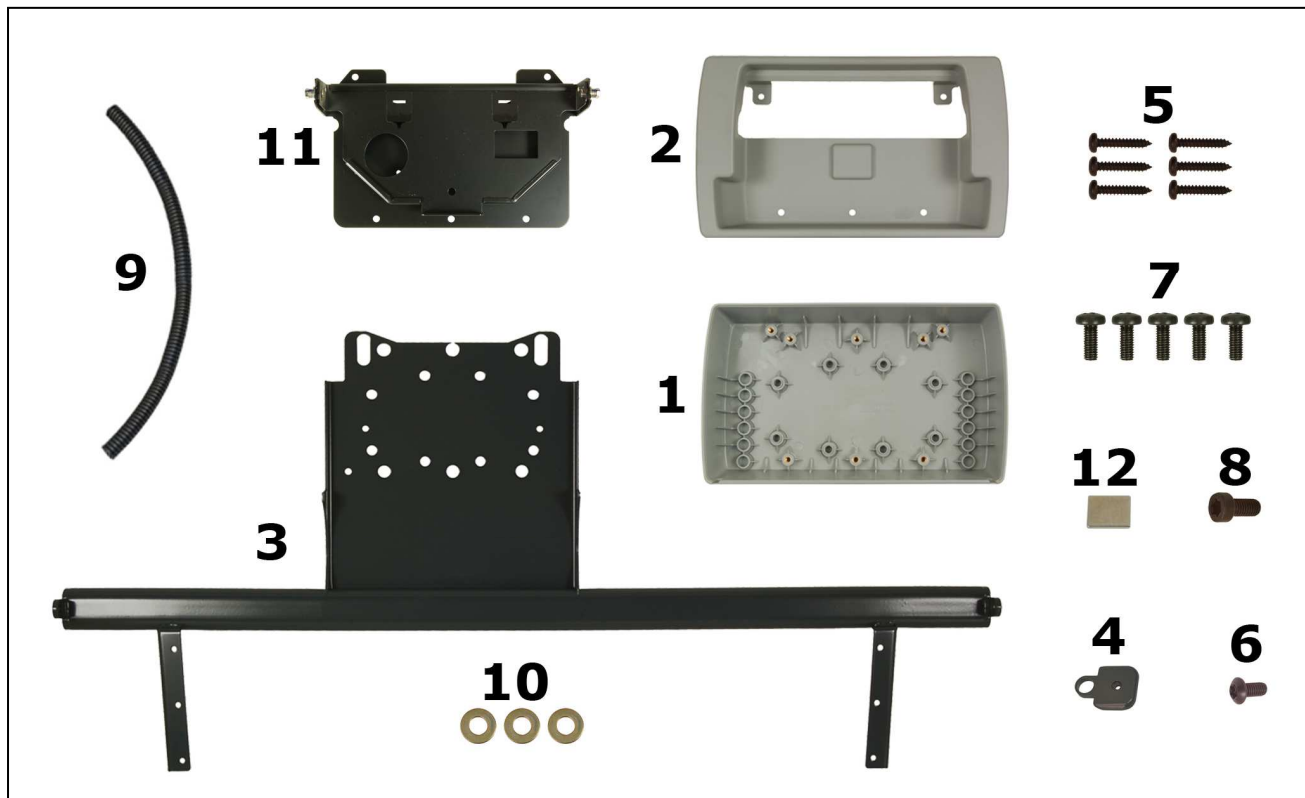

Pos.1	Name	Code	pc/m
1	Rear plastic of monitor holder FMS5723 with slot - grey	068986S1-M	1
2	Front plastic of monitor holder FMS5723 - grey	068987S-M	1
3	Monitor holder for Front Box MB Setra 2010>	0190004	1
4	Side holder cover of Front Box MB Setra 2010>	0810307-M	1
5	Self- tapping screw 4,2x16mm Torx - black	104BN132744,2x16C	6
6	Screw M4x8mm with half- rounded head - allen - black	104BN19M4x8C	1
7	Screw M5x12mm with half- rounded head - cross-slot - black	105BN384M5x12C	5
8	Screw M8x16mm with cylinder head Torx - black	108BN4850M8x30C	1
9	Plastic duct D12,7mm/10,1mm demountable	1926660	0,5
10	Pad Ø8mm	108BN715D8	3
11	Monitor bracket FMS5722 + hinges - tipping 60° for Front Box	FMS5723040-60-M	1
12	Magnet - 28mmx23mmx8,0mm for monitor Funtoro	NH138	1

